

Salient Features

- Transportation Facilities to and from Kathmandu.
- Canteen with subsidized rate for breakfast, lunch, snacks, tea etc.
- Accommodation in boys and girls hostel
- Well Established Library with books and Journal access.
- On site learning provisions
- Dedicated Laboratory for Structure based Courses
- Regular Field and Site Visits.



Lecture Hall

Scholarship and Collaborations

The University has its criteria for providing scholarship to students. Visit the website below for further details
www.ku.edu.np

KU has MOU with many foreign universities and has student and faculty exchange programs with some of them. For the architecture course, KU is collaborating with ICIMOD, NTNU, SPA, FIT etc.

“Quality Education for Leadership”



B.Arch First Batch with Faculty Department of Civil & Geomatics Engineering

School of Engineering
Dhulikhel, Kavre, P.O Box 6250,
Kathmandu Nepal
Phone: 977-11-661399 Ext # 1109
Fax: 977-11-661443



Full equipped Free hand sketch Studios

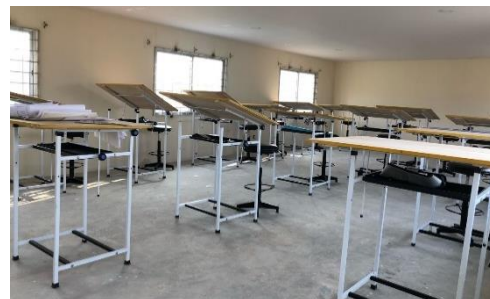

Well Established drawing studio

www.ku.edu.np/dcge



KATHMANDU UNIVERSITY



Bachelor of Architecture

Department of Civil & Geomatics
Engineering (DCGE)



Teaching to design for extremes of Nepal

Bachelor of Architecture

Nepal has entered into the era of economic prosperity and social development. Nepal faces dual challenge of conserving the traditional character of her existing settlements and creating completely new settlements that can provide modern amenities to the growing population. The need of architects will grow further in the years to come.

Architecture course in KU shall be designed to address the need of the Nepalese society- both urban and rural, in shaping a sustainable, eco-friendly and livable built environment. However, to give it a distinct character, the course has been tailored to focus more on mountain architecture. The project work shall focus preferably on green and sustainable building design, landscaping and rural architecture in the context of mountain environment. The graduate of KU shall be able to design not only complex buildings and structures; they will also be able to design buildings in difficult and complex site conditions.

5 year course on semester basis

Course Outline

First Year First Semester

MATH 105 Engineering Mathematics I
 ENGT 103 Communication Skills I (English)
 ARCH 111 History of Architecture I
 ARCH 121 Design Studio I
 ARCH 151 Art Appreciation and Practice I
 ARCH 131 Architectural Drawing and Graphics I
 ARCH 101 Building Sciences I

First Year Second Semester

MATH 106 Engineering Mathematics II
 ---- Communication Skills II (Nepali)
 ARCH 112 History of Architecture II
 ARCH 161 Building Material I
 ARCH 142 Design Studio II
 ARCH 152 Art Appreciation and Practice II
 ARCH 132 Architectural Drawing and Graphics II
 ARCH 171 Workshop I

Second Year First Semester

ARCH 213 Applied Mechanics
 ARCH 241 Engineering Survey I
 ARCH 203 History of Architecture III
 ARCH 243 Design Studio III
 ARCH 221 Building Construction I
 ARCH 233 Architectural Drawing and Graphics III
 ARCH 272 Workshop II

Second Year Second Semester

ARCH 231 Strength of Material
 ARCH 242 Engineering Survey II
 ARCH 252 Building Material II
 ARCH 244 Design Studio IV
 ARCH 222 Building Construction II
 ARCH 202 Building Sciences II

Third Year First Semester

ARCH 331 Theory of Structure
 MGTS 303 Engineering Economics
 ARCH 305 Building Regulation
 ARCH 331 Working Drawing I & CAD
 ARCH 345 Design Studio V
 ARCH 351 Mountain Architecture
 ARCH 319 Building Services I

Third Year Second Semester

ARCH 341 Design of Steel, Masonry and Timber Structure
 ARCH 306 Estimation and Valuation
 ARCH 332 Working Drawing II & CAD
 ARCH 346 Design Studio VI
 ARCH 323 Building Construction III
 ARCH 331 Building Services II

Fourth Year First Semester

ARCH 441 Design of RCC Structures
 ARCH 435 Landscape Design
 ARCH --- Elective I
 ARCH 441 Interior Design I
 ARCH 447 Design Studio VII
 MEPP 451 Building Services III

Fourth Year Second Semester

ARCH 421 Seminar and Directed Studies
 CIEG 403 Construction Management
 ARCH --- Elective II
 MGTS 402 Entrepreneurship
 ARCH 448 Design Studio VIII

Fifth Year First Semester

ARCH 451 Internship
 ARCH 449 Mini Project

Fifth Year Second Semester

ARCH 471 Architectural Design Thesis
 ARCH 461 Professional Ethics



Students discussing with Guest Lecturer

Focused Internship for Four Months

Admission Requirement

Candidates should have completed 10+2 or equivalent degree from a recognized academic institution with minimum 50% marks in aggregate and minimum 50% marks in physics, mathematics and chemistry or computer will meet primary eligibility requirements. For details visit: www.ku.edu.np/

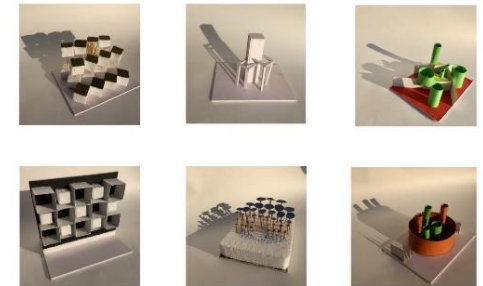

Students project in Design Studio workshop

Career Opportunities

Architecture graduates will be employed in the following organizations as assured by the stakeholders

- Government ministries & departments
- Private sector in Infrastructure development activities
- NGOs/INGOs
- International job market (Universities, Private and public companies)

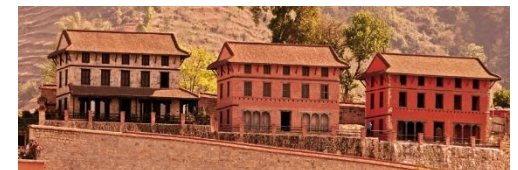

Supporting and Promoting Vernacular Architecture

Five Year Course Fee: NPR 750,000/-*